



15. Metal caps

| Shell size | For use with connectors | Part numbers | Packaging |
|------------|-------------------------|--------------|------------|
| E | Male | 8655-3148 | 50 pieces |
| | Female | 8655-3113 | 100 pieces |
| | | 8655-3138* | 50 pieces |
| A | Male | 8655-3149 | 50 pieces |
| | Female | 8655-3114 | 100 pieces |
| | | 8655-3139* | 50 pieces |
| B | Male | 8655-3150 | 50 pieces |
| | Female | 8655-3115 | 100 pieces |
| | | 8655-3140* | 50 pieces |
| C | Male | 8655-3151 | 50 pieces |
| | Female | 8655-3116 | 100 pieces |
| | | 8655-3141* | 50 pieces |
| D | Male | 8655-3152 | 50 pieces |
| | Female | 8655-3117 | 100 pieces |
| | | 8655-3142* | 50 pieces |



Material: steel

Plating: cadmium

To obtain with tin plating, add suffix "T" to end of part number.

*sealed caps IP 65

16. Attaching cord for metal caps

8655.3156 (length = 100 mm)
Packaging: individual



17. Plastic dust cap

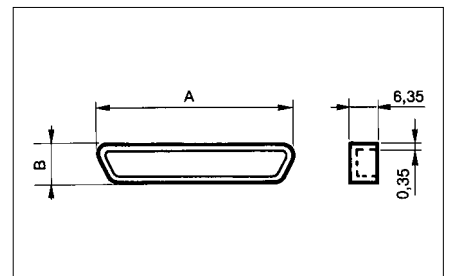

| Shell size | For male connector | A | B | For female connector | A | B |
|------------|--------------------|-------|-------|----------------------|-------|-------|
| E | 70508 | 19.17 | 10.30 | 70513 | 17.77 | 9.00 |
| A | 70509 | 27.50 | 10.30 | 70514 | 26.10 | 9.00 |
| B | 70510 | 41.67 | 10.70 | 70515 | 39.82 | 9.00 |
| C | 70511 | 58.13 | 10.70 | 70516 | 56.28 | 9.00 |
| D | 70512 | 55.49 | 13.40 | 70517 | 53.89 | 11.85 |

Material: thermoplastic

Color: red

Packaging: per 100 pieces