

Front panels

Front panels for plug-in units

Extruded front panels

Aluminum 2.5 mm, clear anodized (non-conductive)

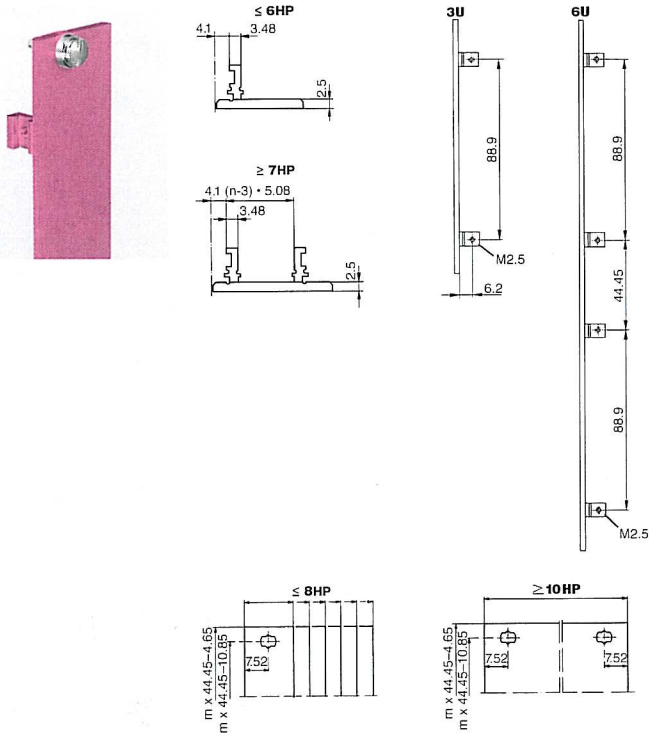

Width	B		Height		
	mm	inch	3U	4U	6U
			128,7 mm 5.15"	173,1 mm 6.92"	262,0 mm 10.48"
3HP	15.0	0.59	26N303	-	26N603
4HP	20.1	0.79	26N304	26N404	26N604
5HP	25.2	0.99	26N305	26N405	26N605
6HP	30.3	1.19	26N306	26N406	26N606
7HP	35.3	1.38	26N307	26N407	26N607
8HP	40.4	1.59	26N308	26N408	26N608
10HP	50.6	1.99	26N310	26N410	26N610
12HP	60.7	2.38	26N312	26N412	26N612
14HP	70.9	2.79	26N314	26N414	26N614
16HP	81.1	3.19	26N316	-	26N616
21HP	106.5	4.19	26N321	-	-

Fixing material has to be ordered separately (page 132-135)

raw version: 26Nxxx-0

at rear drill marks for handle-fixing holes!

Rigid-mounted unit handles with identification label

black, plastic UL94V-0, label aluminum anodized

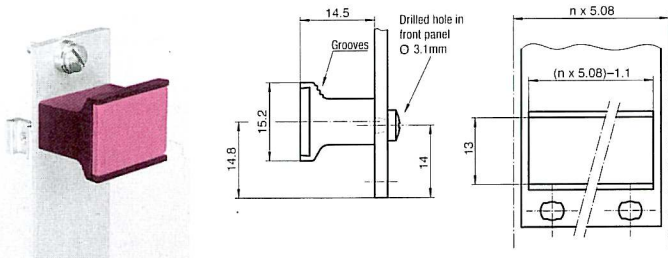

Width		Packing unit	Part No.
4HP TOP	(flat front panel with card holder)	5	60-200-01
4HP BOTTOM	(flat front panel with card holder)	5	60-200-02
4HP Standard		10	60-200-04
5HP		10	60-200-05
6HP		10	60-200-06
7HP		10	60-200-07
8HP		10	60-200-08
10HP		10	60-200-10
12HP		10	60-200-12
14HP		1	60-200-14
21HP		1	60-200-21

Fixing material

Part	Packing unit	Part No.
Philips round head screw	100 pcs.	1902-70